

Kevin Williams
Principal engineer
Kingston & Sutton Shared Environment Service
Tel: 020 8770 5000
Date: 12 October 2023

Dear Resident,

Proposed parking changes for Belmont

Following our informal consultation in May 2023 we are now moving to a final consultation about proposed parking changes for your street.

Proposal for Chiltern Road, Heath Drive and The Highway

We are proposing some changes in these roads due parking pressures from the hospital and nearby school (see detailed maps on the back of this letter). The proposals include:

- Changing the operating hours of single yellow lines in Chiltern Road, Heath Drive and The Highway (to Monday to Friday 8am-10am and 2.30pm-5pm).
- New double yellow lines on a short section of Heath Drive and Chiltern Road.
- New single yellow lines on a short section of Chiltern Road (operating Monday to Friday 8am to 10am and 2.30pm to 5pm).
- Extending the zebra crossing zig zags and introducing bus stop markings on Chiltern Road outside the school.

We are not proposing any changes to Bassett Close.

Have your say

This is your final chance to let us know if you agree or disagree with the proposals or have another view. You can provide feedback online: sutton.gov.uk/-/parking-review

This final stage of consultation will end on **26 October 2023**.

If you do not have access to the internet, you can provide your feedback in writing to Parking Strategy Review, Highways & Transport, Civic Office, St Nicholas Way, Sutton, SM1 1EA.

Yours faithfully,

Kevin Williams
Principal Engineer, Kingston & Sutton Shared Environment Services

Heath Drive

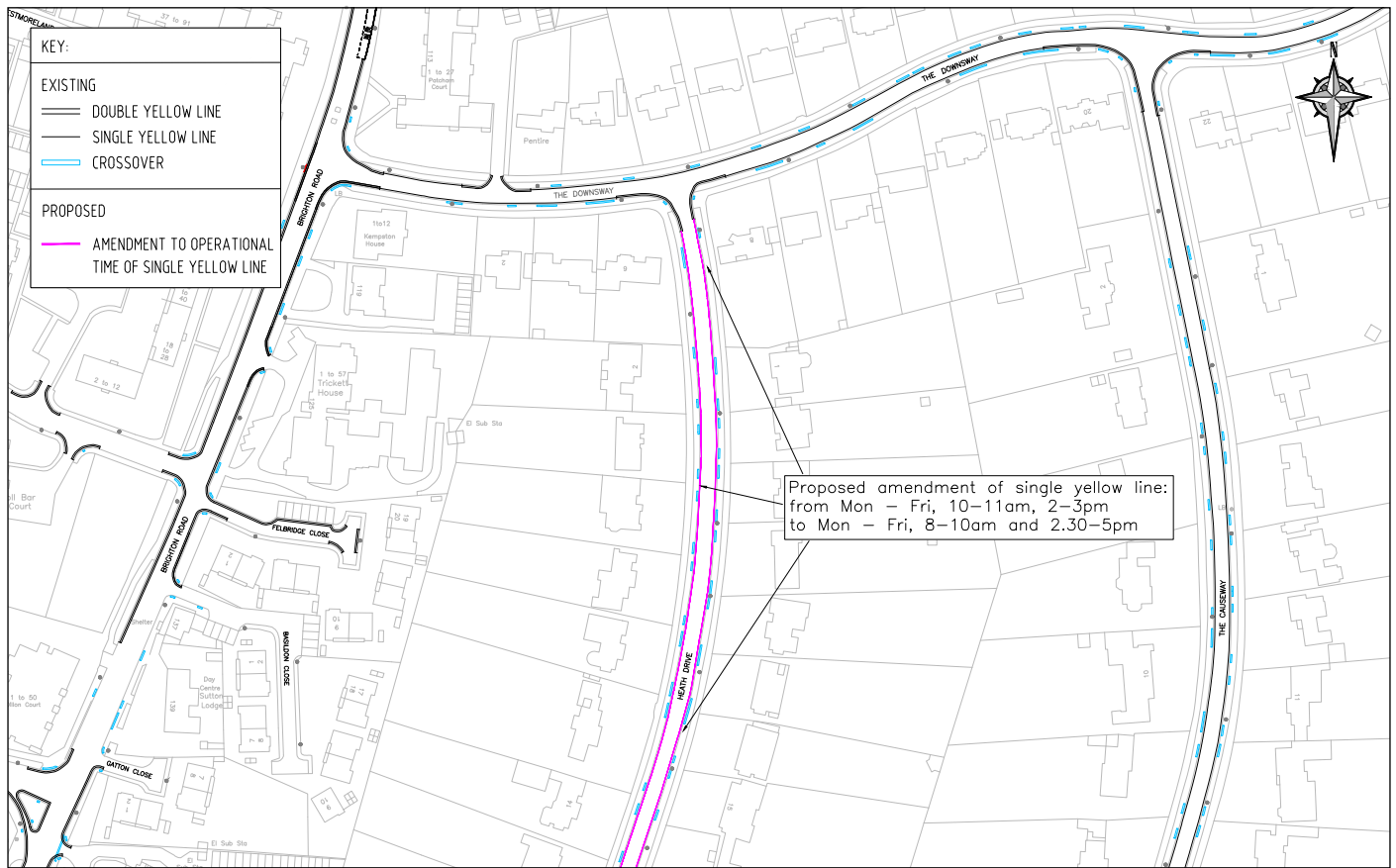

Chiltern Road, Heath Drive and The Highway

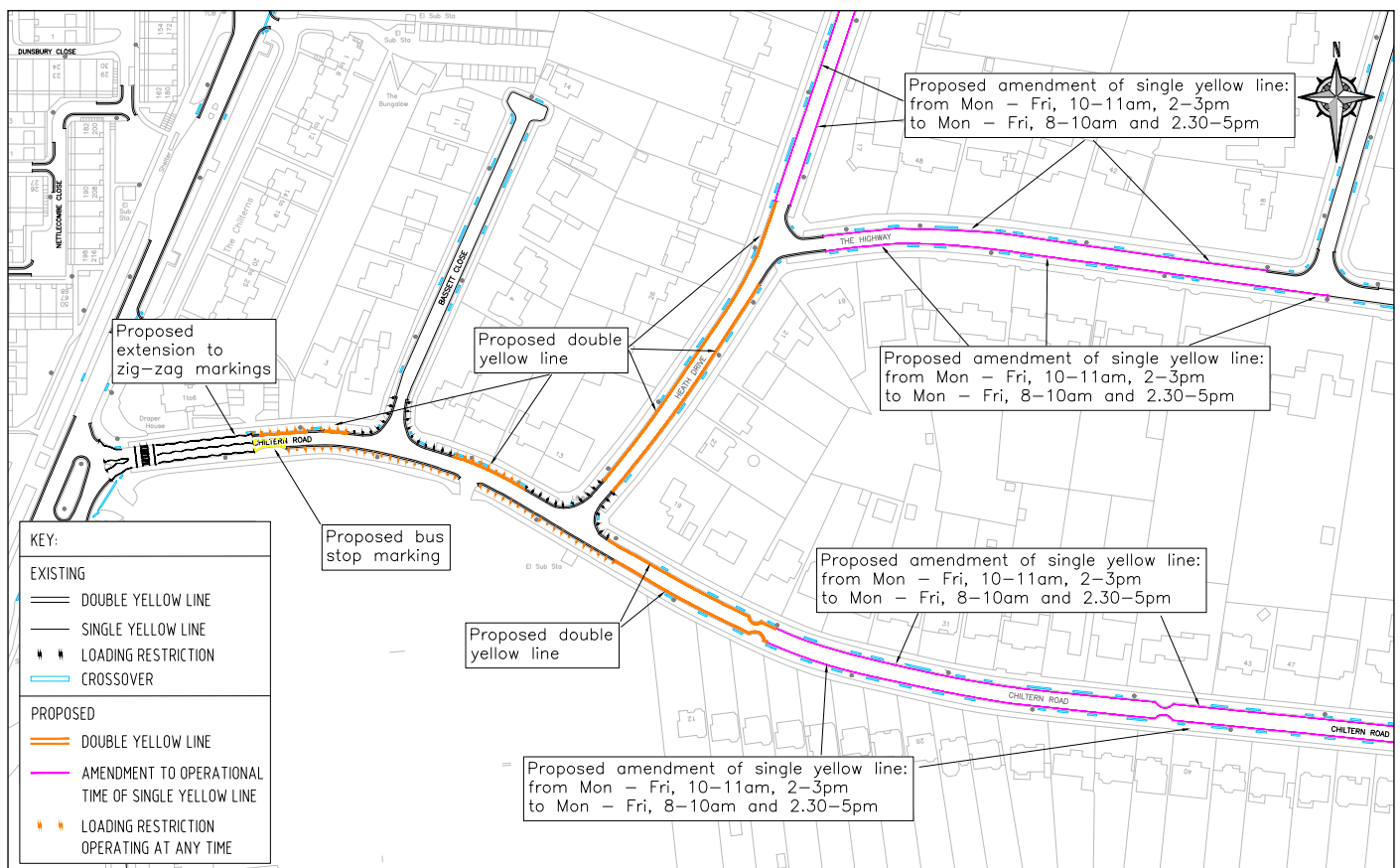

Chiltern Road

