

Kevin Williams
Parking Programme Manager
Kingston & Sutton Shared Environment
Service
Tel: 020 8770 5000
Date: 15 February 2024

Dear Resident,

Proposed parking changes for Meller Close

We're writing to you as part of our ongoing review of parking in Sutton.

Parking remains one of the issues of most concern to residents in Sutton and we have received many requests for a review of parking arrangements across the borough.

Proposal for Meller Close

Following local requests we are proposing double yellow lines from No 7 to No 11 Meller Close due to access issues **(see detailed map on the back of this letter)**.

Have your say

This is your first chance to let us know if you agree or disagree with the proposals, have another view or have further feedback about parking. You can provide feedback online: www.sutton.gov.uk/-/parking-review.

This informal stage of consultation will end on **29 February 2024**. We will review the feedback and speak with ward councillors before a decision is made whether to progress any formal proposals for changes.

If you do not have access to the internet, you can provide your feedback in writing to Parking Strategy Review, Highways & Transport, Civic Office, St Nicholas Way, Sutton, SM1 1EA.

Yours faithfully,

Kevin Williams
Principal Engineer, Kingston & Sutton Shared Environment Services

Map: Proposals for Meller Close

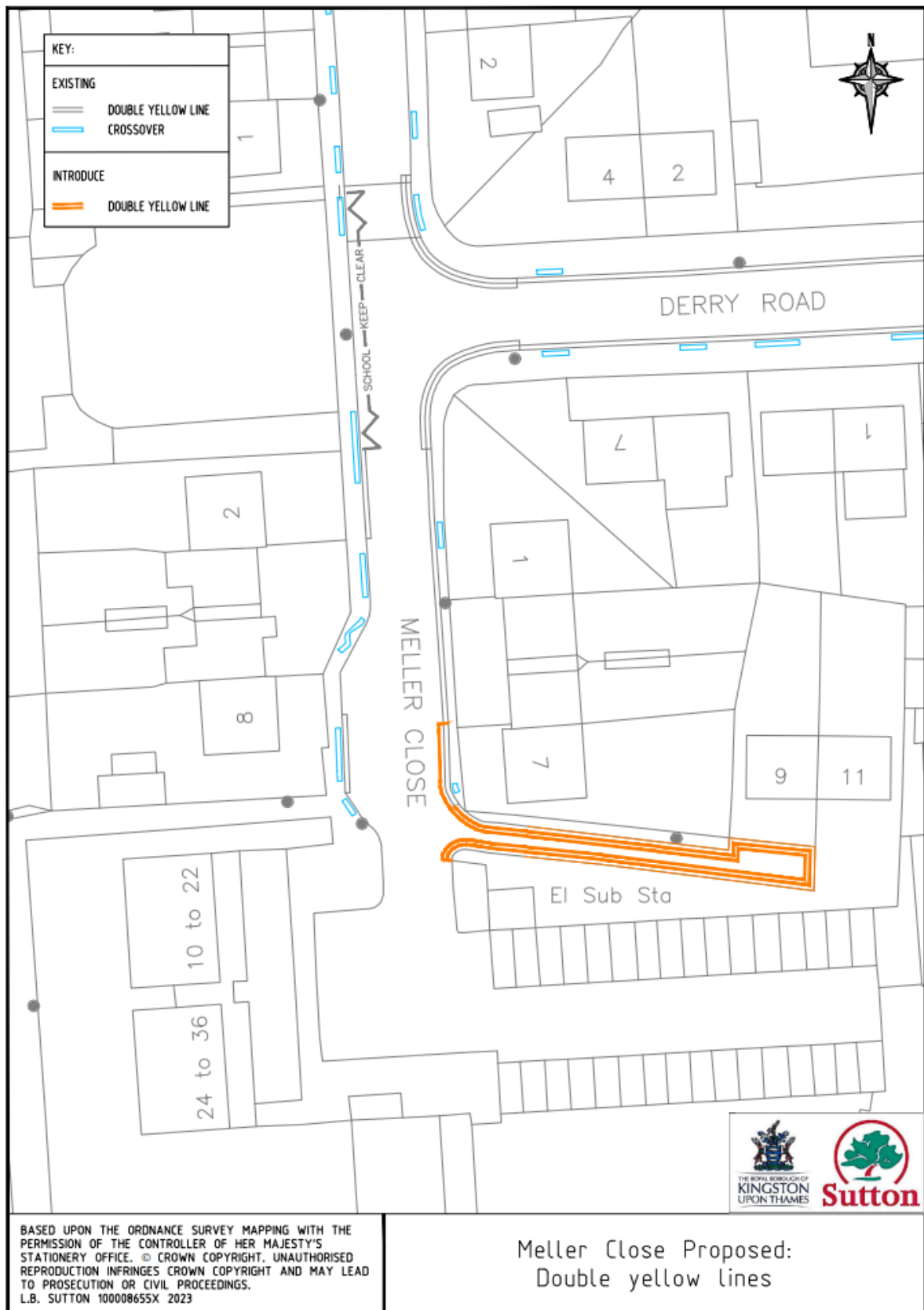

BASED UPON THE ORDNANCE SURVEY MAPPING WITH THE PERMISSION OF THE CONTROLLER OF HER MAJESTY'S STATIONERY OFFICE. © CROWN COPYRIGHT. UNAUTHORISED REPRODUCTION INFRINGES CROWN COPYRIGHT AND MAY LEAD TO PROSECUTION OR CIVIL PROCEEDINGS. L.B. SUTTON 100008655X 2023

Meller Close Proposed:
Double yellow lines



PS-1000-38-01-06